

## General Setup Instructions

- Read entire setup instruction manual prior to unpacking parts and pieces.
- The setup instructions are created specifically for this configuration.
- Setup instructions are laid out sequentially in steps, including exploded views with detailed explanation for assembly.

## Cleaning & Packing

- For Cleaning Metal, Plex, & Laminate Parts: Use a **MILD NON-ABRASIVE** cleanser and soft cloth/paper towel to clean all surfaces.
- Keep exhibit components away from heat and prolonged sun exposure.  
**Heat and UV exposure will warp and fade components.**
- Retain all provided Packing Materials. All provided packing materials are for ease of repacking & component protection.

## Disassembly

- For loss prevention, tighten all setscrews and locks during disassembly

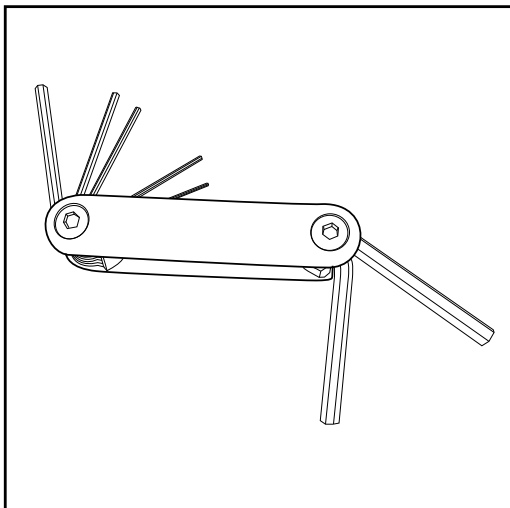

Hex Tool - Essential for Assembly

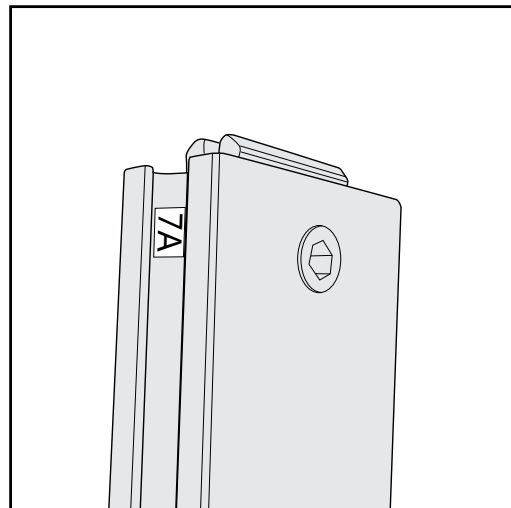

Part Identification - Numbering

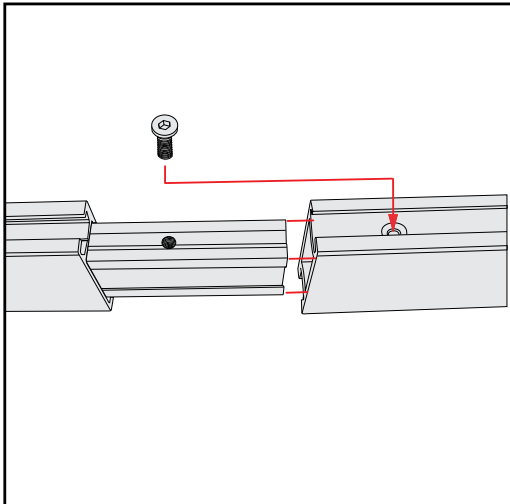

Spline Connection

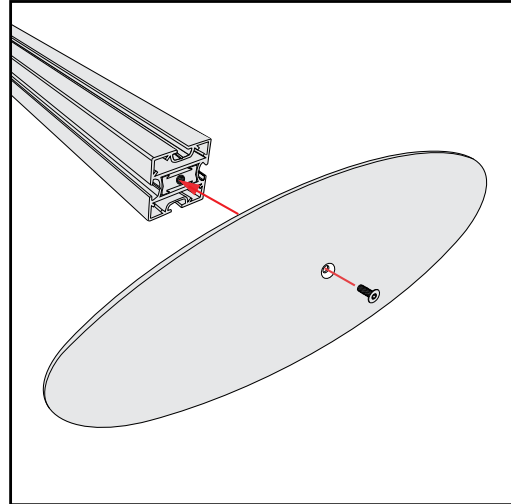

Base Plate & Extrusion Connection

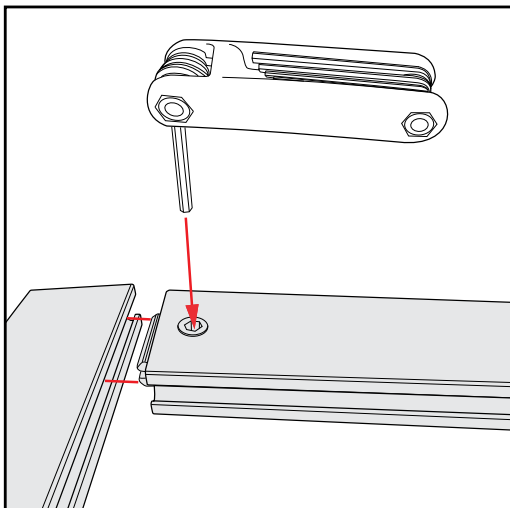

Extrusion & Lock Connection

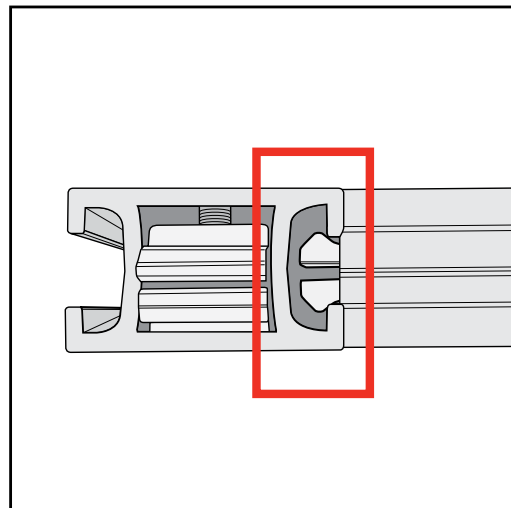

Engaged Lock



# WARNING



DO NOT USE POWER TOOLS

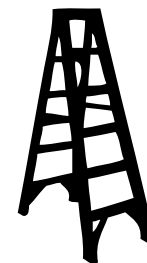

LADDERS OR LIFTS  
MAY BE REQUIRED



ALL CONNECTIONS MUST  
BE TIGHTLY SECURED

## SEG Graphic Installation

- 1) Locate channels along the edges of extrusions
- 2) Insert graphic corners first into channels then center point of graphic into channels. Allows for proportional fit around the perimeter of the extrusion.
- 3) Working from center to corner, slide silicon edge on graphic into channel.
- 4) After all edges of graphic have been inserted into channels, step back and assess graphic fit, make adjustments where needed.

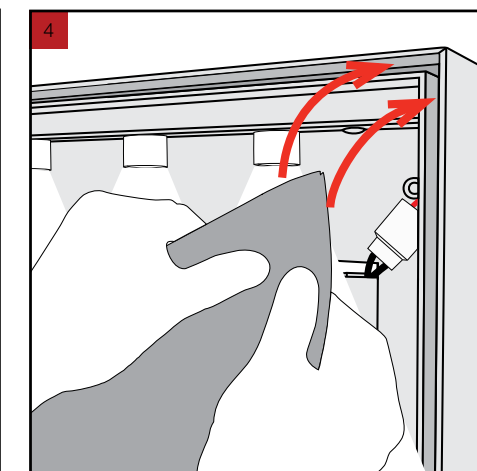
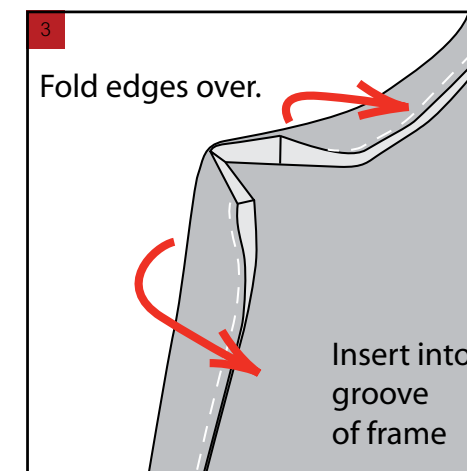
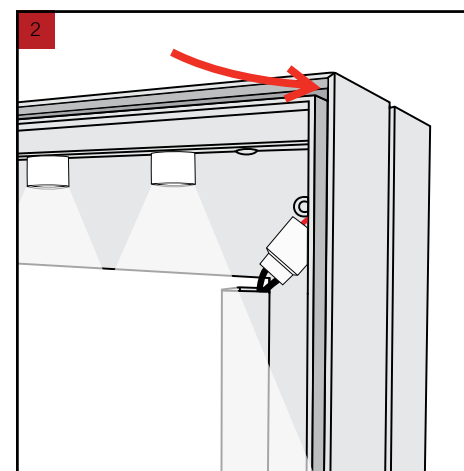
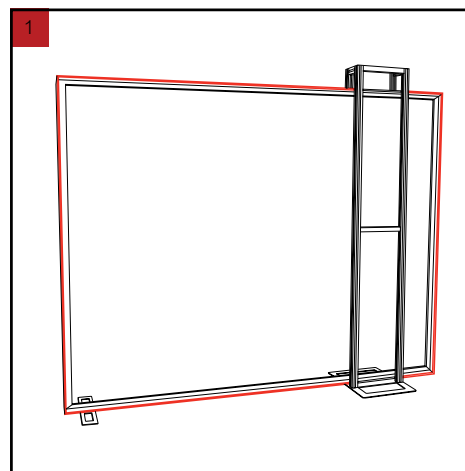



# ***SETUP INSTRUCTIONS***

If you would like to tell us about your experience with your setup instructions please email us at [info@classicexhibits.com](mailto:info@classicexhibits.com)

Item	Qty.	Description
1	1	95.75"h TSP49 Vertical Extrusion
2	1	95.75"h TSP49 Vertical Extrusion
3	1	88.5151" TSP49 Curved Horizontal Extrusion
4	1	88.5151" TSP49 Curved Horizontal Extrusion
5	1	88.5151" TSP49 Curved Horizontal Extrusion
6	1	88.5151" TSP49 Curved Horizontal Extrusion
7	1	92.1680"h Z45 Vertical Extrusion
8	1	92.1680"h Z45 Vertical Extrusion
9	1	48" TSP49 Curved Horizontal Extrusion
10	1	48" TSP49 Curved Horizontal Extrusion

- Steps for assembly [A]:
- 1) Connect TSP49 frame extrusions [1-6] together.  
Refer to **TSV1 Lock Detail**. See detail C, general info page for horizontal connections.
  - 2) Attach verticals [7,8] between TSP49 horizontals.
  - 3) Attach horizontals [9,10] between verticals [7,8].

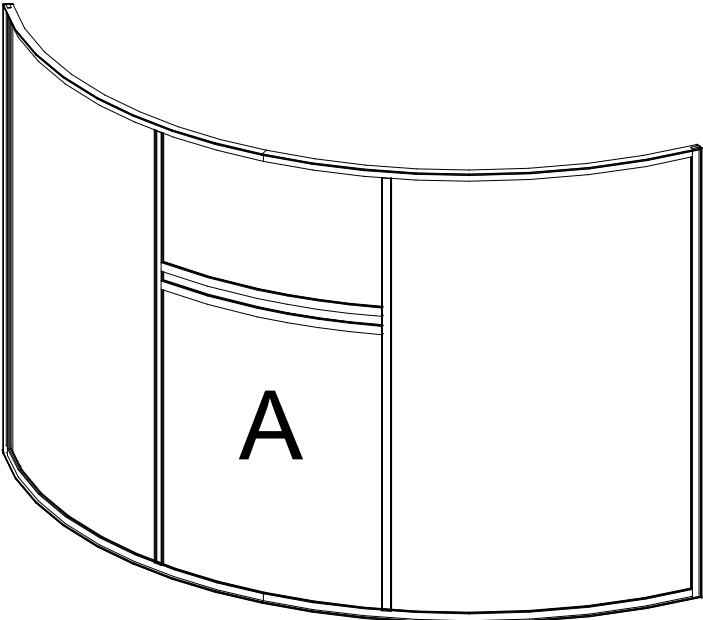
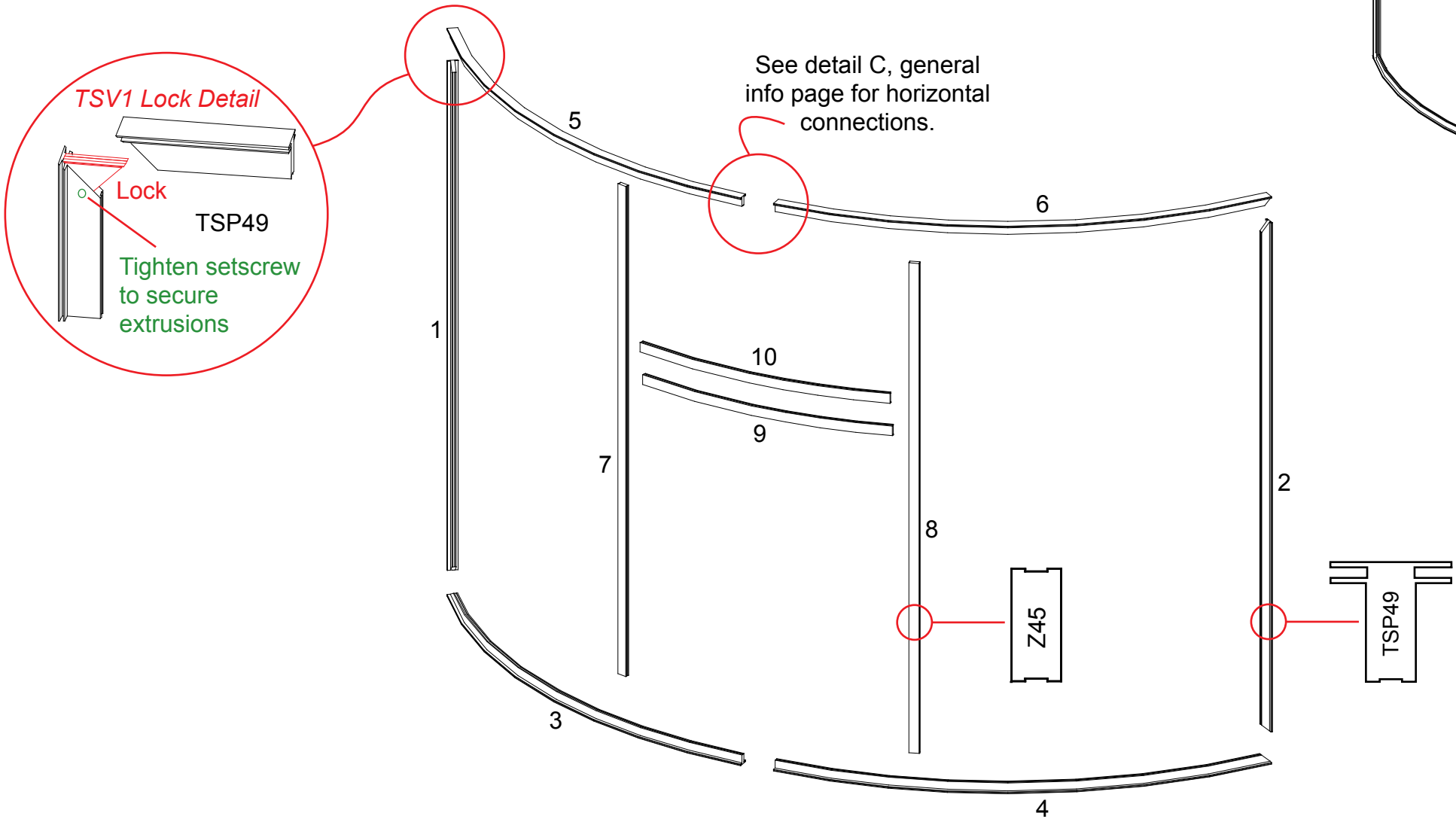

Item	Qty.	Description
11	1	95.75"h TSP49 Vertical Extrusion
12	1	95.75"h TSP49 Vertical Extrusion
13	1	88.5151" TSP49 Curved Horizontal Extrusion
14	1	88.5151" TSP49 Curved Horizontal Extrusion
15	1	88.5151" TSP49 Curved Horizontal Extrusion
16	1	88.5151" TSP49 Curved Horizontal Extrusion
17	1	92.1680"h Z45 Vertical Extrusion
18	1	92.1680"h Z45 Vertical Extrusion
19	1	95.75"h TSP49 Vertical Extrusion
20	1	95.75"h TSP49 Vertical Extrusion
21	1	67.7067" TSP49 Curved Horizontal Extrusion
22	1	67.7067" TSP49 Curved Horizontal Extrusion
23	1	92.1680"h Z45 Vertical Extrusion

- Steps for assembly [B]:
- 1) Connect TSP49 frame extrusions [11-16] together.  
Refer to **TSV1 Lock Detail**. See detail C, general info page for horizontal connections.
  - 2) Attach verticals [17,18] between TSP49 horizontals.

- Steps for assembly [C]:
- 1) Connect TSP49 frame extrusions [19-22] together.  
Refer to **TSV1 Lock Detail**.
  - 2) Attach vertical [23] between TSP49 horizontals.

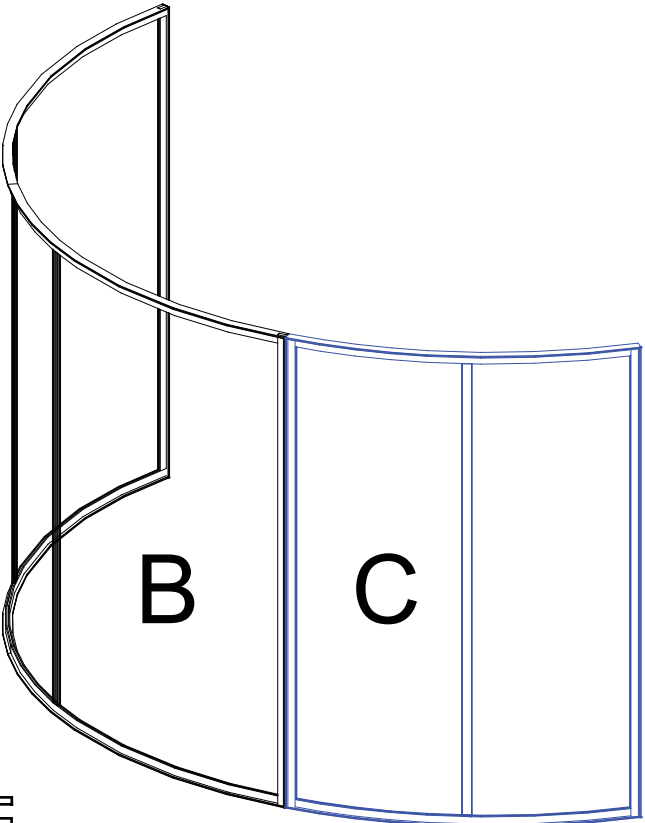

When assembled

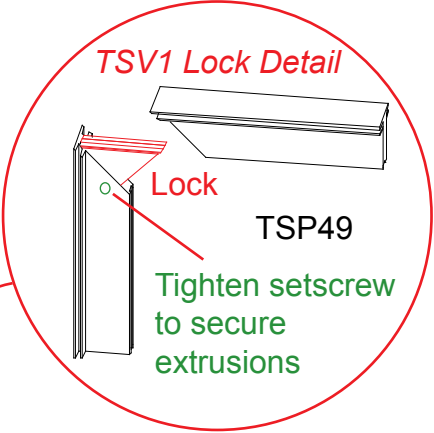
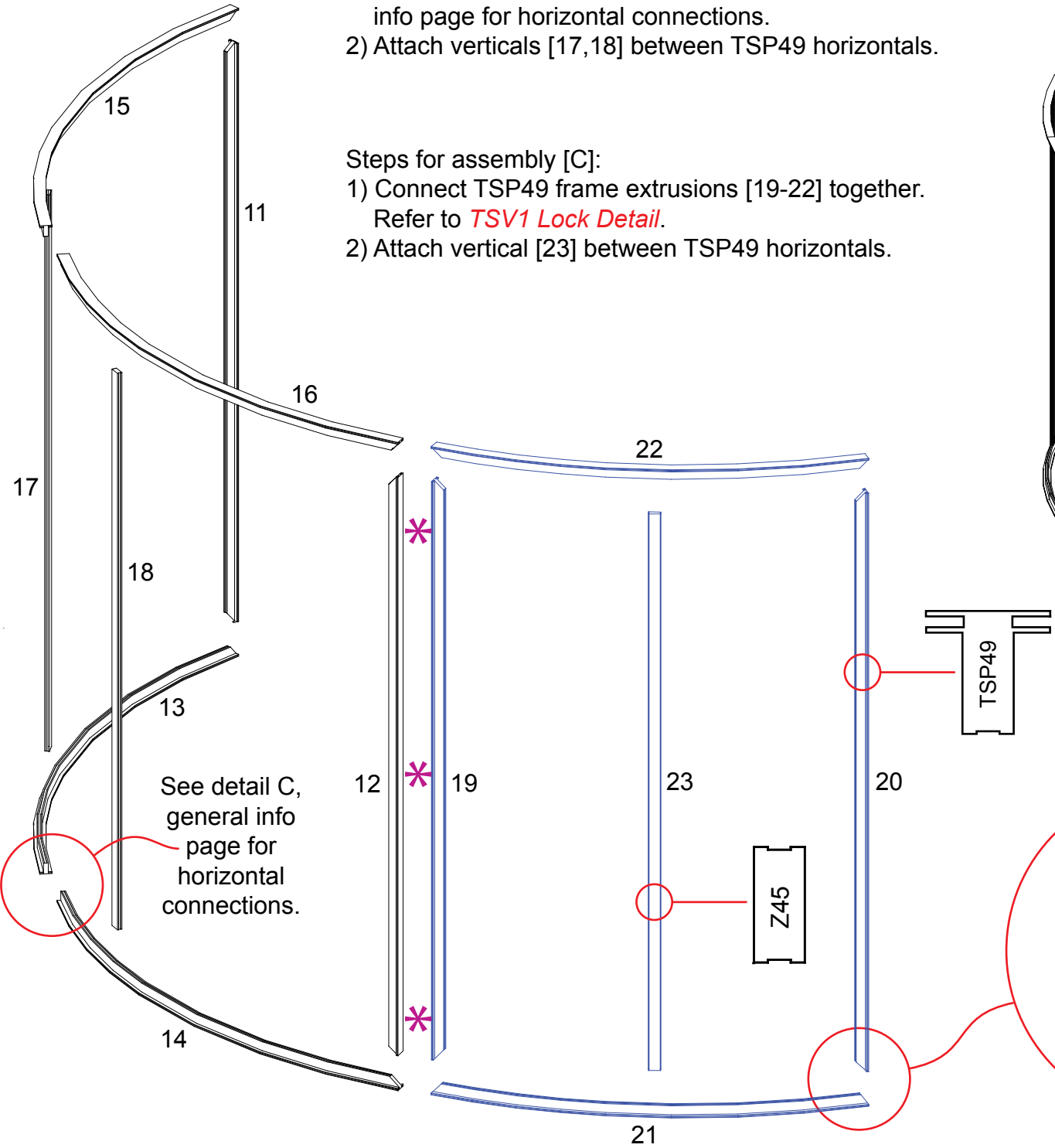
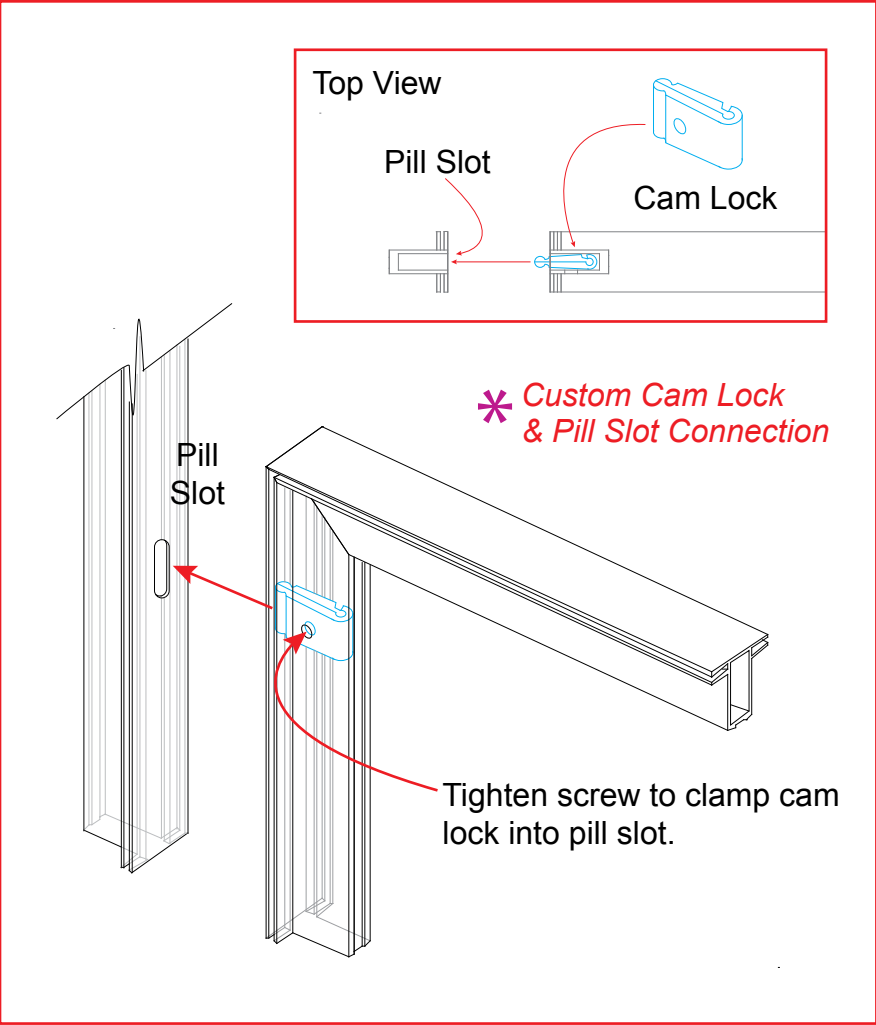



Item	Qty.	Description
24	1	48"h TSP49 Vertical Extrusion
25	1	48"h TSP49 Vertical Extrusion
26	1	96.5618" TSP49 Curved Horizontal Extrusion
27	1	96.5618" TSP49 Curved Horizontal Extrusion
28	1	44.4180"h Z45 Vertical Extrusion
29	1	44.4180"h Z45 Vertical Extrusion

- Steps for assembly [D]:
- 1) Connect TSP49 frame extrusions [24-27] together.  
Refer to *TSV1 Lock Detail*.
  - 2) Attach verticals [28,29] between TSP49 horizontals.

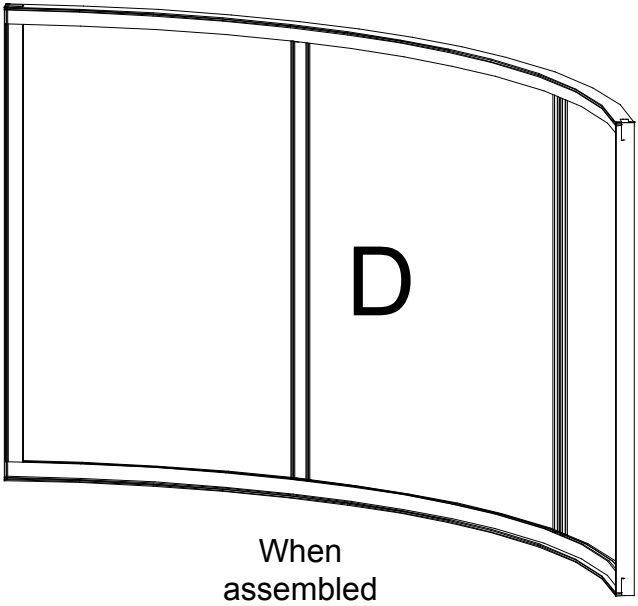
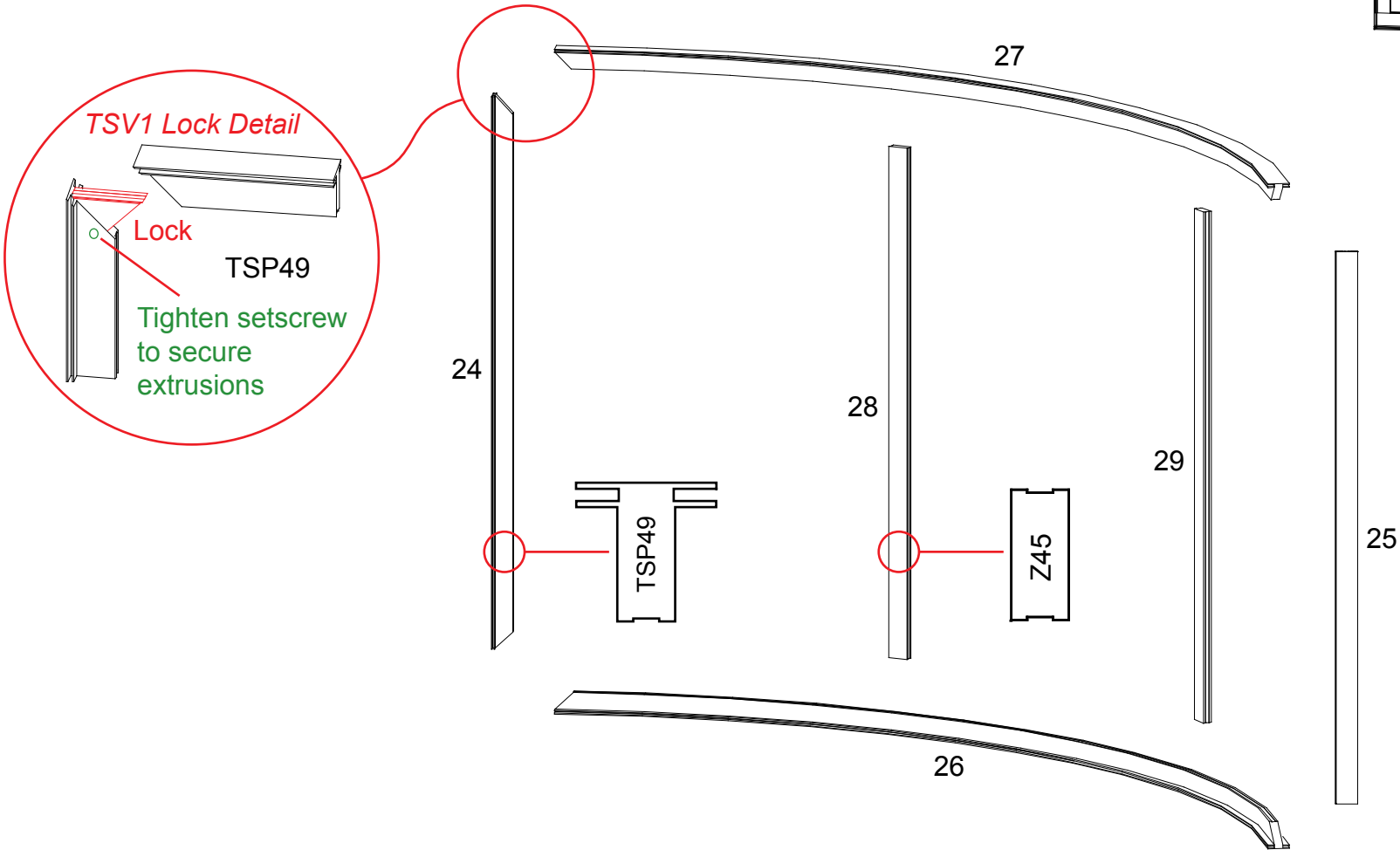

Steps for assembly [E]:

- 
- Diagram illustrating the exploded view of a window frame assembly. The components are labeled as follows:
- 30**: Left vertical frame member.
  - 31**: Right vertical frame member.
  - 32**: Bottom horizontal frame member.
  - 33**: Top horizontal frame member.
  - 34**: Middle vertical frame member.
  - 35**: Middle vertical frame member (right side).
  - Z45**: Locking pin/rod.
  - TSP49**: Locking pin/rod (right side).
  - TSV1 Lock Detail**: Detail view showing the lock mechanism, including the **Lock** and **TSP49** components. A note indicates: "Tighten setscrew to secure extrusions".
  - When assembled**: Label indicating the final assembled state of the window frame.



Item	Qty.	Description
36	1	Oval Base Plate
37	1	95.75"h S44 Vertical Extrusion
38	1	95.75"h S44 Vertical Extrusion
39	1	96"h S44 Vertical Extrusion w/ Hinge
40	1	Oval Base Plate
41	1	95.75"h S44 Vertical Extrusion w/ Hinge
42	1	95.75"h S44 Vertical Extrusion
43	1	Oval Base Plate
44	1	95.75"h S44 Vertical Extrusion
45	1	48"h S44 Vertical Extrusion

Steps:

- 1) Attach base plates [36,40,43] to lower verticals [37,41,44] using bolts as shown.
- 2) Attach upper verticals [38,42,45] to lower verticals [37,41,44].
- 3) Attach lower assembled SEG frames [A,D] between verticals [37,39,44]. Refer to custom cam lock detail.
- 4) Attach upper assembled SEG frames [B,C,E] between vertical assemblies. Refer to custom cam lock detail. Note: Connect upper SEG frames to lower SEG frames using bolts and wing nuts as shown.
- 5) Attach iPad mount to vertical [44]. Refer to detail.

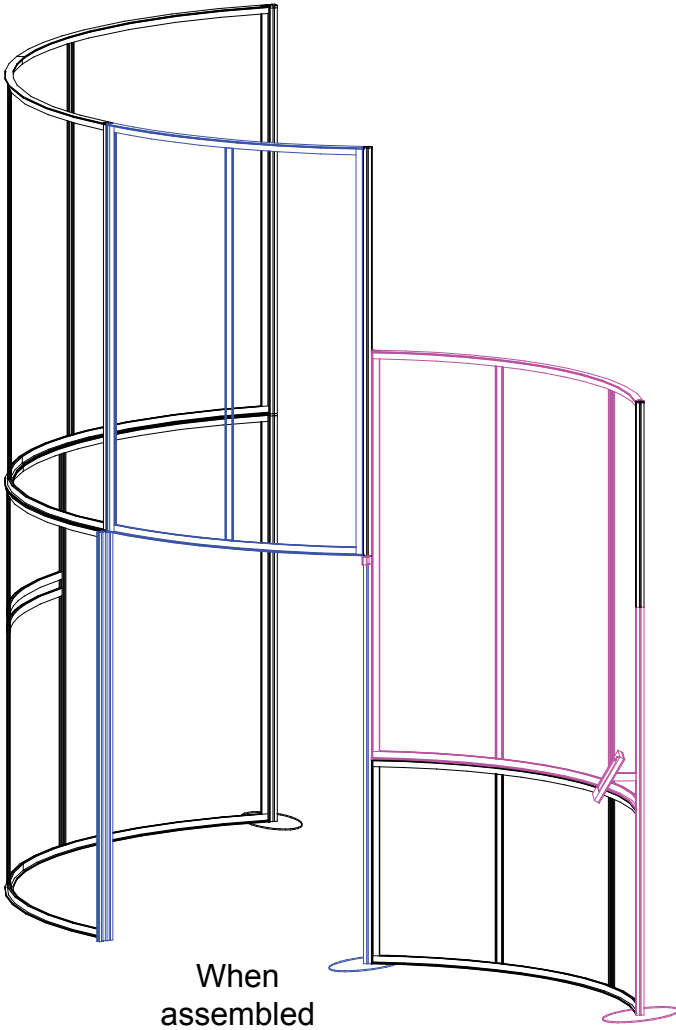
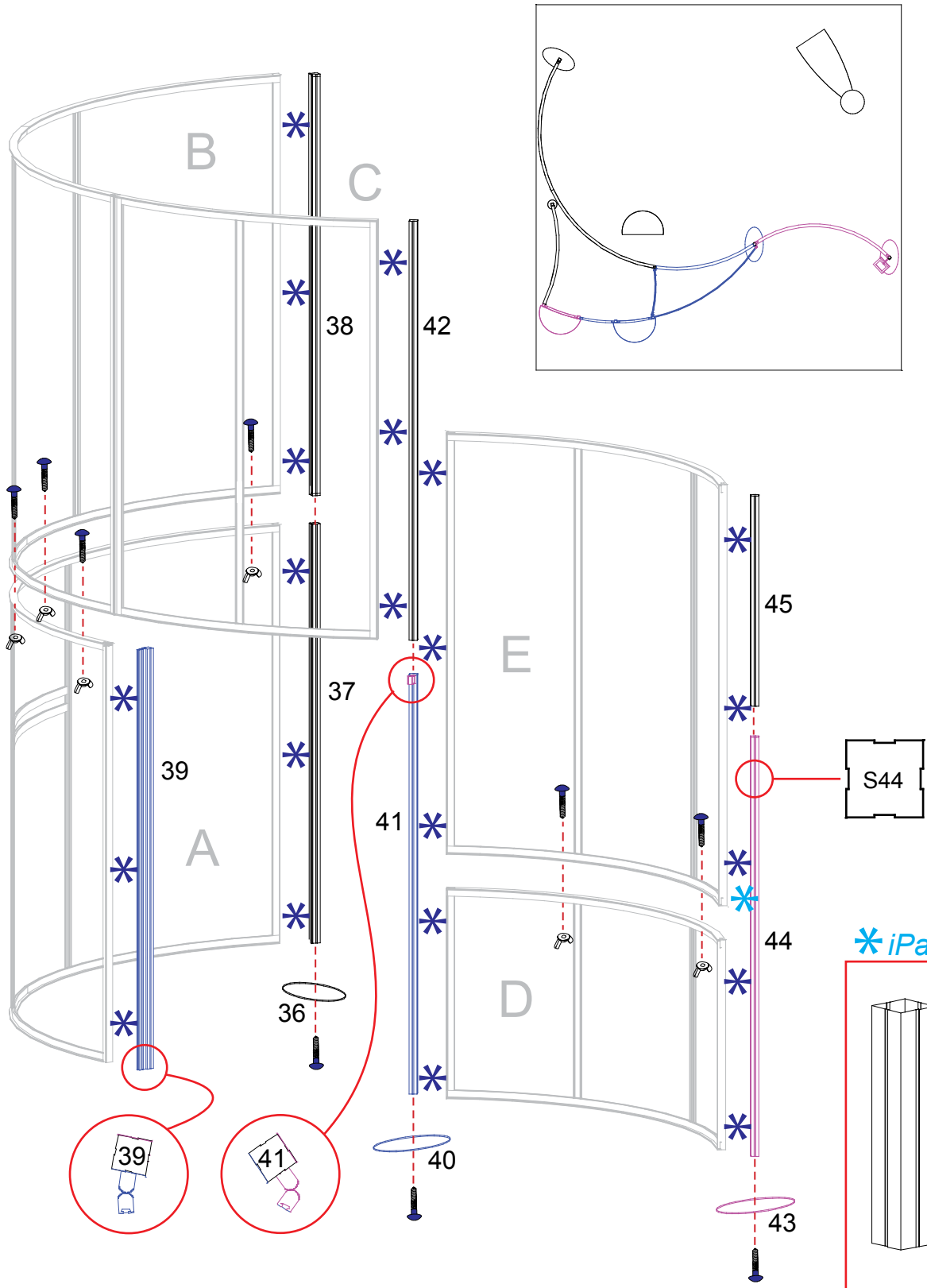
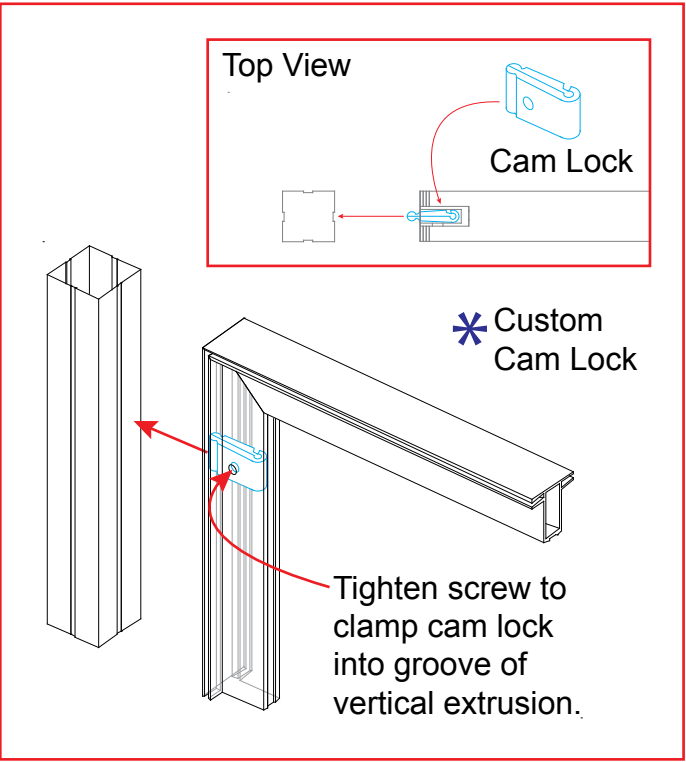

\* iPad Mount Attachment

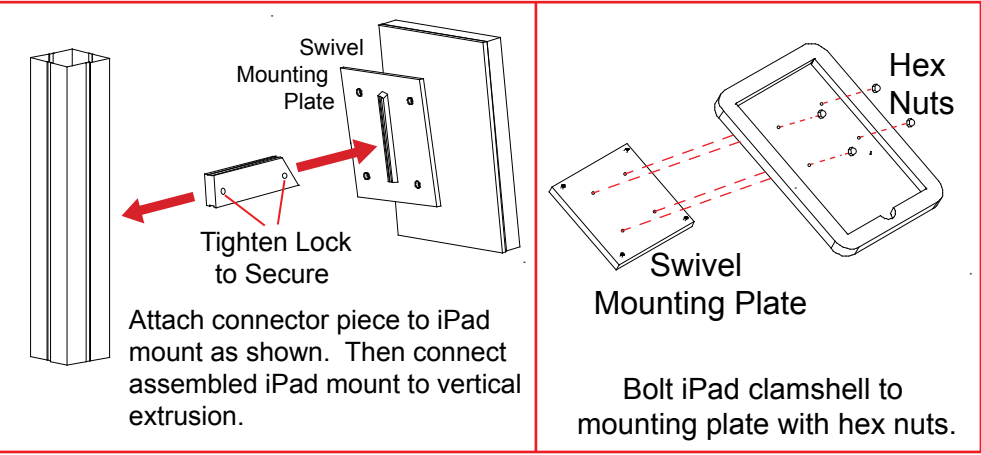

Item	Qty.	Description
46a	1	96"h TSP49 Vertical Extrusion
47a	1	96"h TSP49 Vertical Extrusion
49a/49b	2/2	96"h TSP49 Vertical Extrusion
50	6	22.9301" TSP49 Curved Horizontal Extrusion
50a	2	19.2098" Z45 Curved Horizontal Extrusion

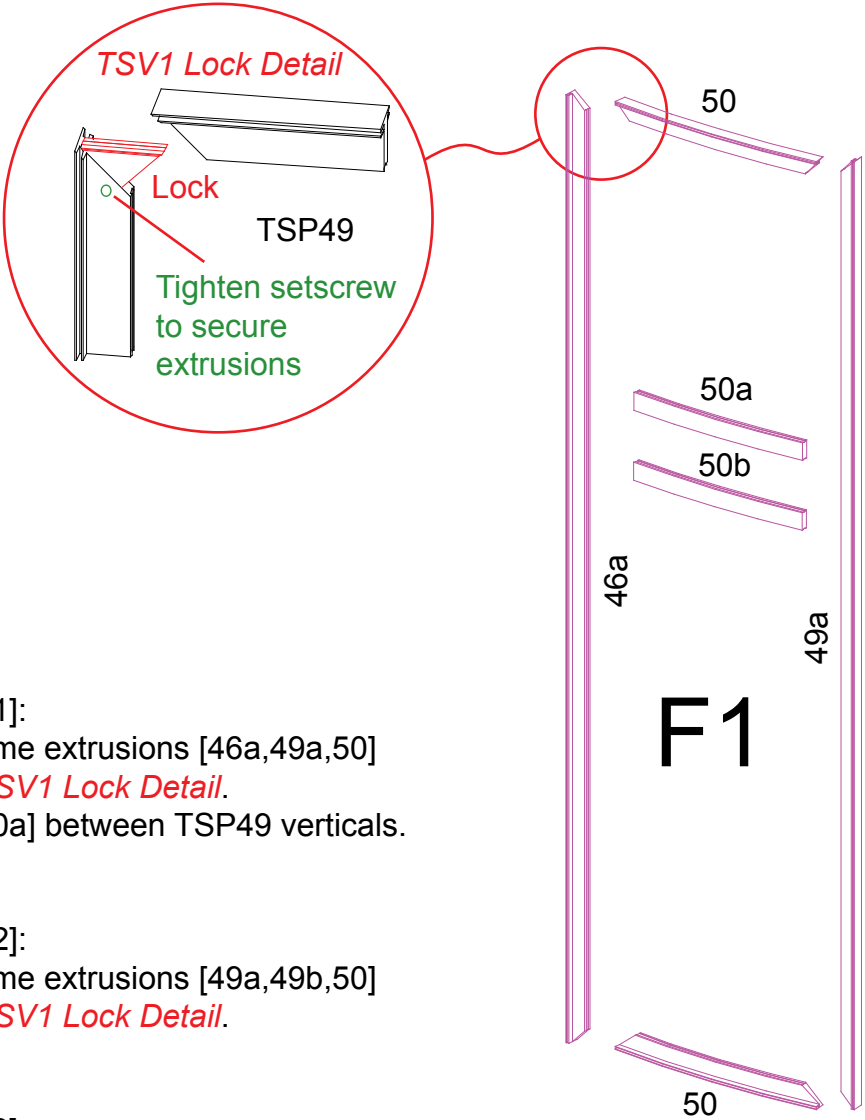

Steps for assembly [F1]:  
1) Connect TSP49 frame extrusions [46a,49a,50] together. Refer to *TSV1 Lock Detail*.  
2) Attach horizontal [50a] between TSP49 verticals.

Steps for assembly [F2]:  
1) Connect TSP49 frame extrusions [49a,49b,50] together. Refer to *TSV1 Lock Detail*.

Steps for assembly [F3]:  
1) Connect TSP49 frame extrusions [47a,49b,50] together. Refer to *TSV1 Lock Detail*.  
2) Attach horizontal [50a] between TSP49 verticals.

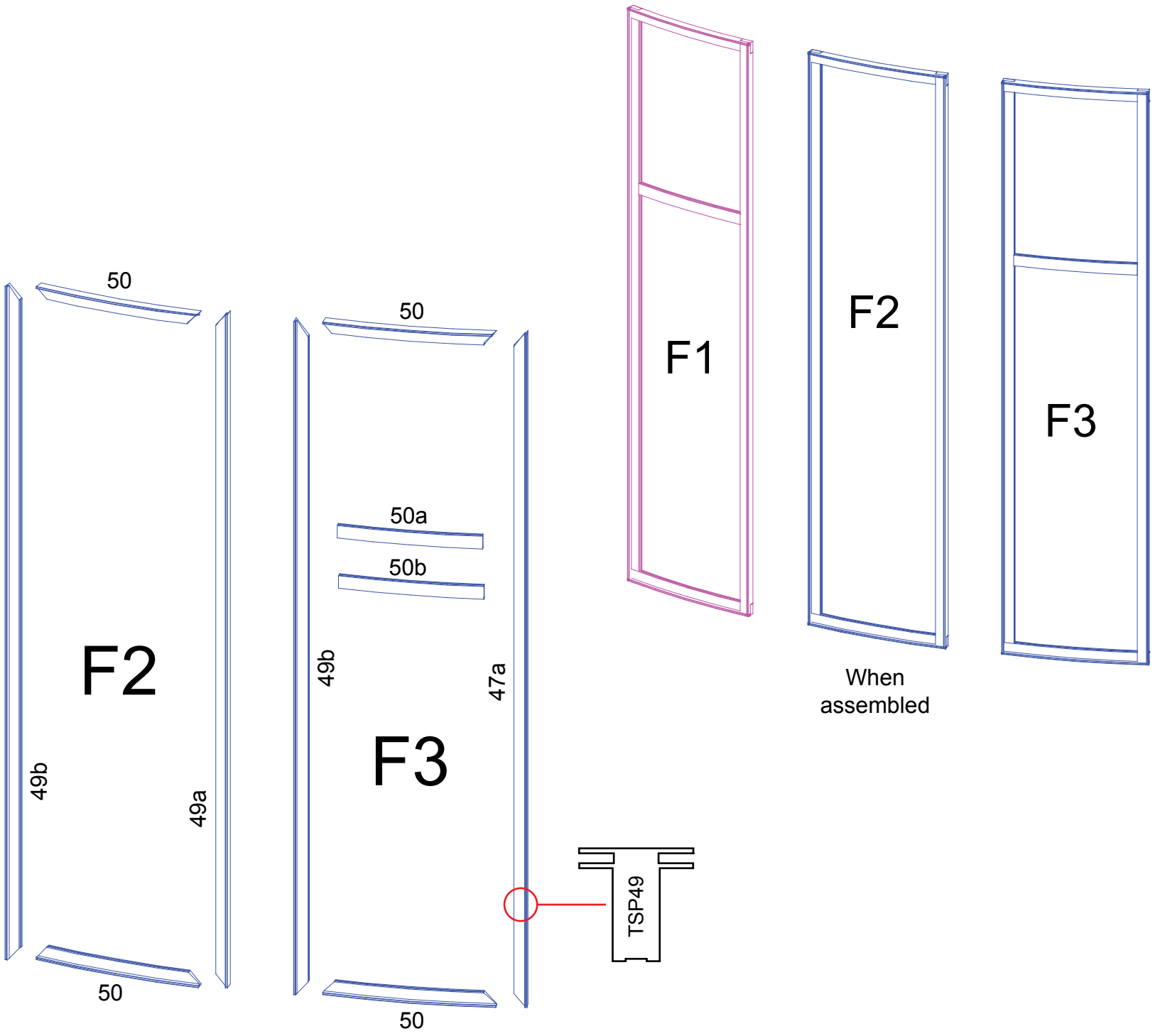

Item	Qty.	Description
39	1	96"h S44 Vertical Extrusion w/ Hinge
46	1	96"h S44 Vertical Extrusion
47	1	96"h S44 Vertical Extrusion w/ Hinge
48	2	27.4515" Z45 Curved Horizontal Extrusion
49	2	96"h S44 Vertical Extrusion

- Steps:
- 1) Attach assembled SEG frames [F1,F2,F3] between verticals [46,47,49]. Refer to custom cam lock detail.
  - 2) Attach door threshold between verticals [47,39]. Refer to detail.
  - 3) Attach door to vertical [39]. Refer to detail.
  - 4) Attach upper curved horizontals [48] and place infill between verticals.

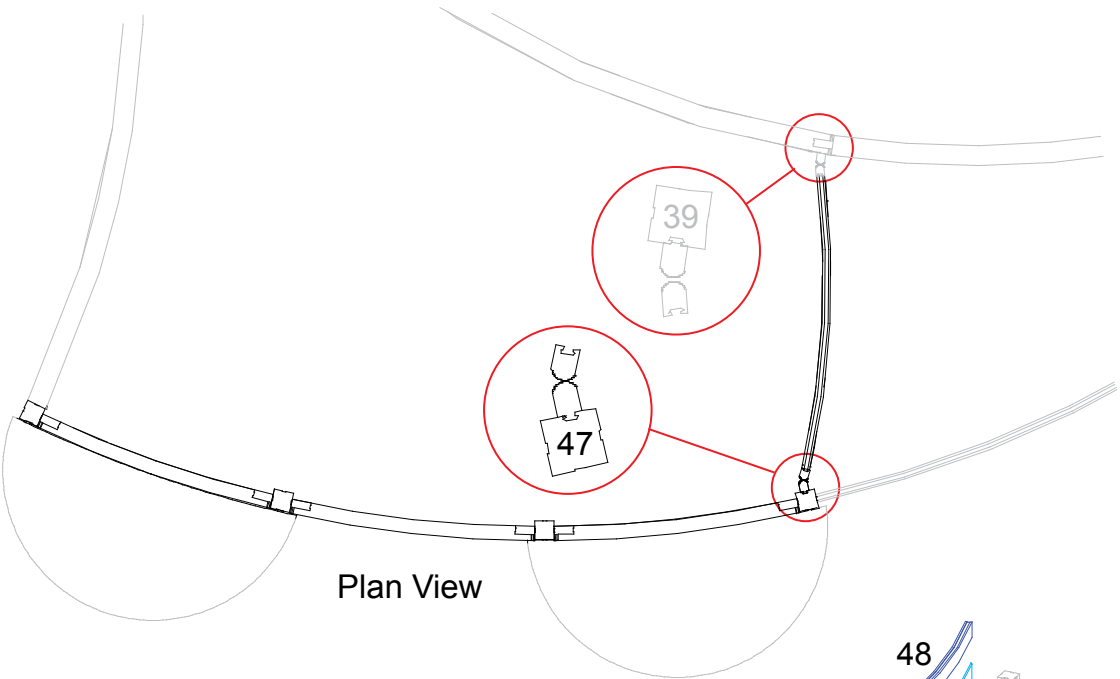

Plan View

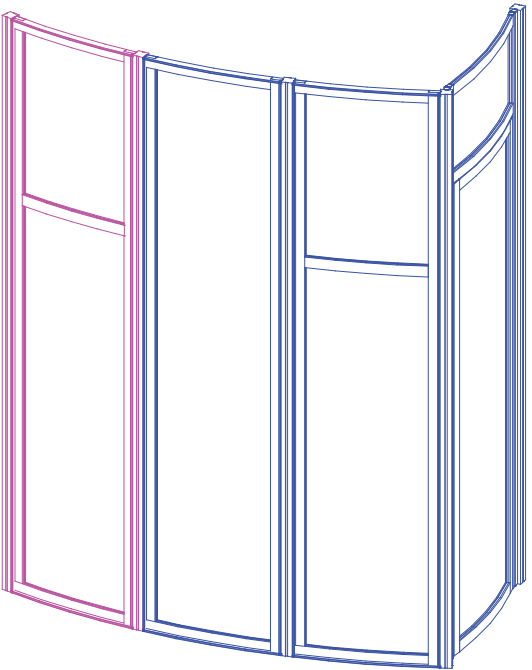

When assembled

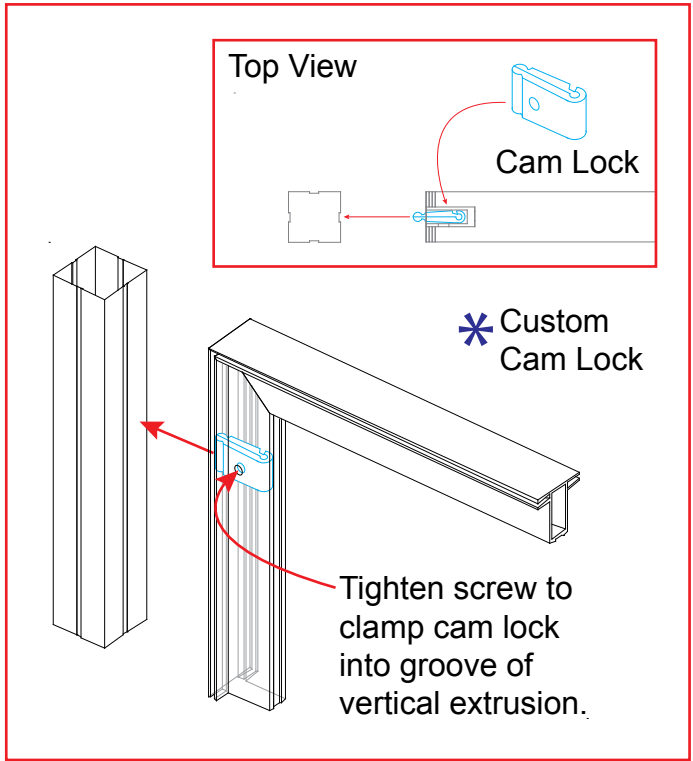

Top View

Cam Lock

\* Custom Cam Lock

Tighten screw to clamp cam lock into groove of vertical extrusion.

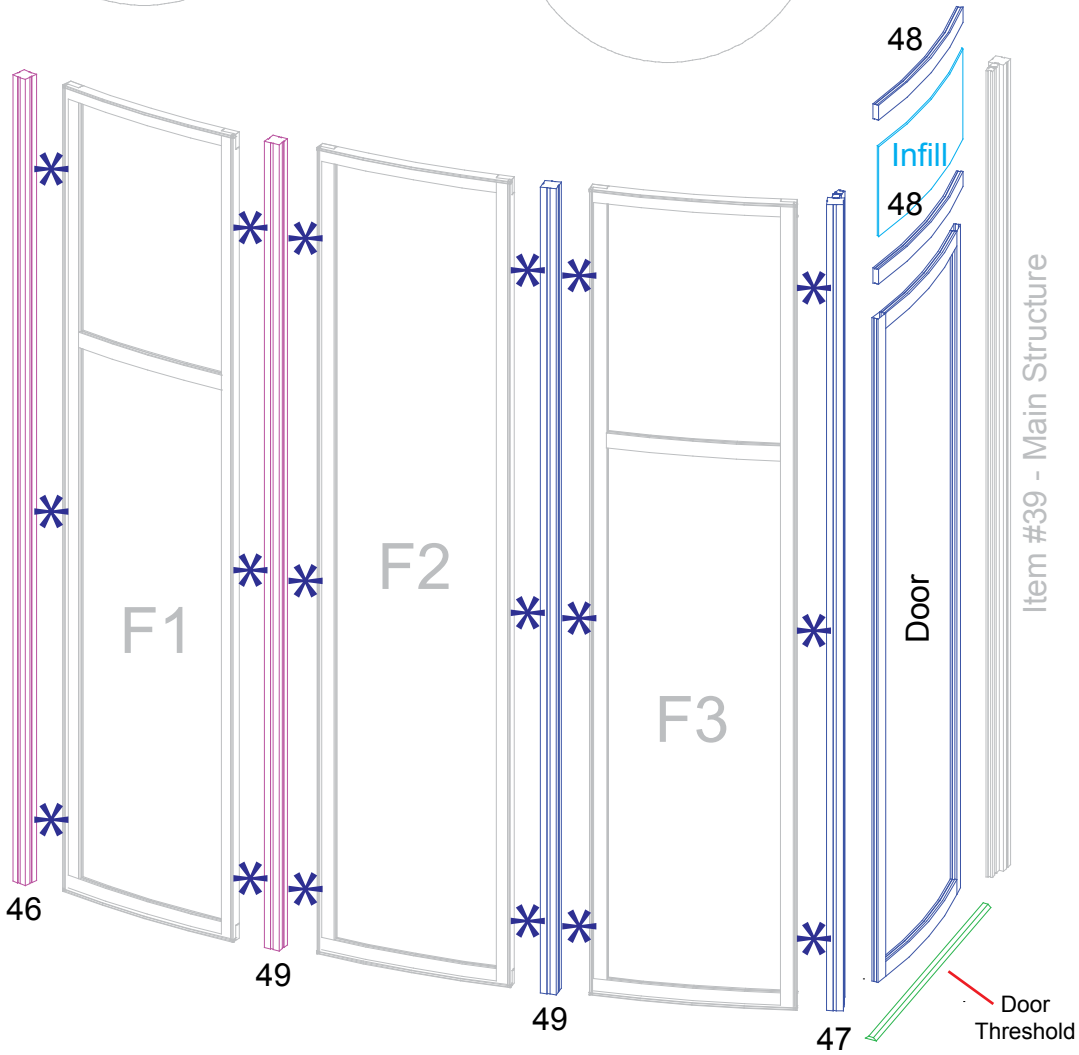

Item #39 - Main Structure

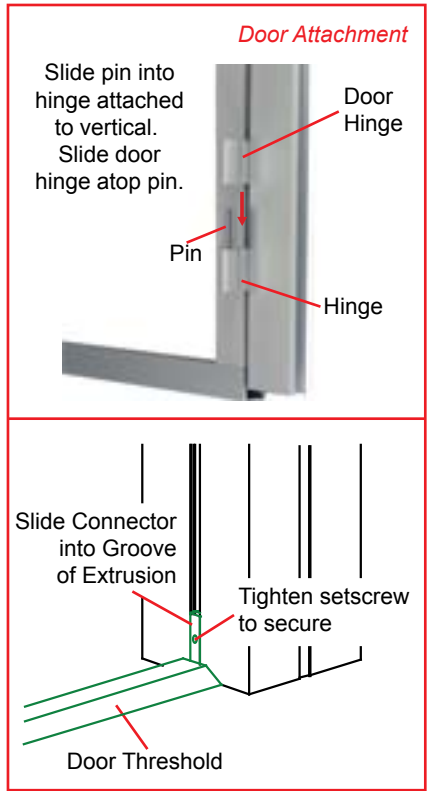

Door Attachment

Slide pin into hinge attached to vertical. Slide door hinge atop pin.

Door Hinge

Pin

Hinge

Slide Connector into Groove of Extrusion

Tighten setscrew to secure

Door Threshold

Item	Qty.	Description
46	1	96"h S44 Vertical Extrusion
51	1	96"h TSP49 Vertical Extrusion
52	1	96"h TSP49 Vertical Extrusion
53	1	66.6995" TSP49 Curved Horizontal Extrusion
54	1	66.6995" TSP49 Curved Horizontal Extrusion
55	1	Round Base Plate
56	1	95.75"h S44 Vertical Extrusion

Steps for assembly [G]:

- 1) Connect TSP49 frame extrusions [51-54] together. Refer to **TSV1 Lock Detail**.
- 2) Attach base plate [55] to vertical [56] using a bolt.
- 3) Attach assembled SEG frame [G] between verticals [46,56]. Refer to custom cam lock detail.

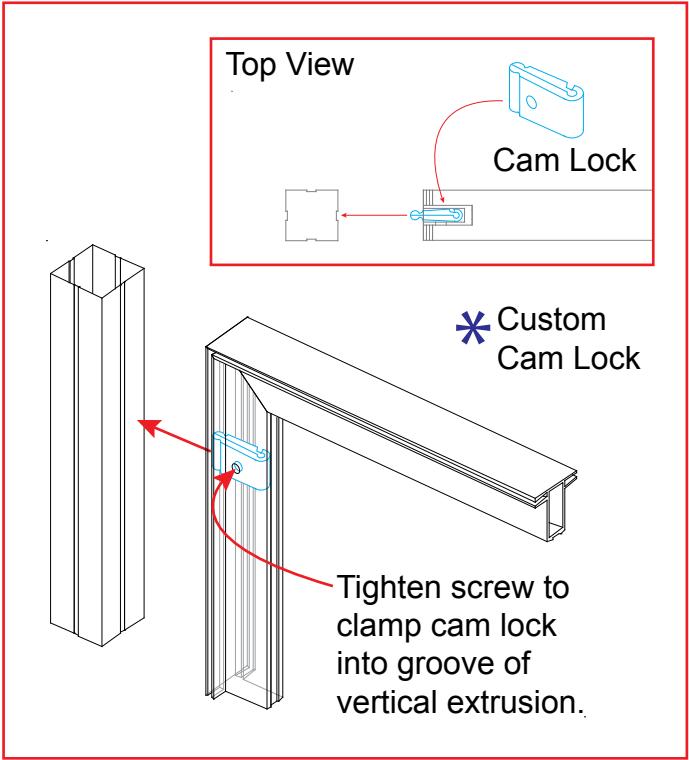
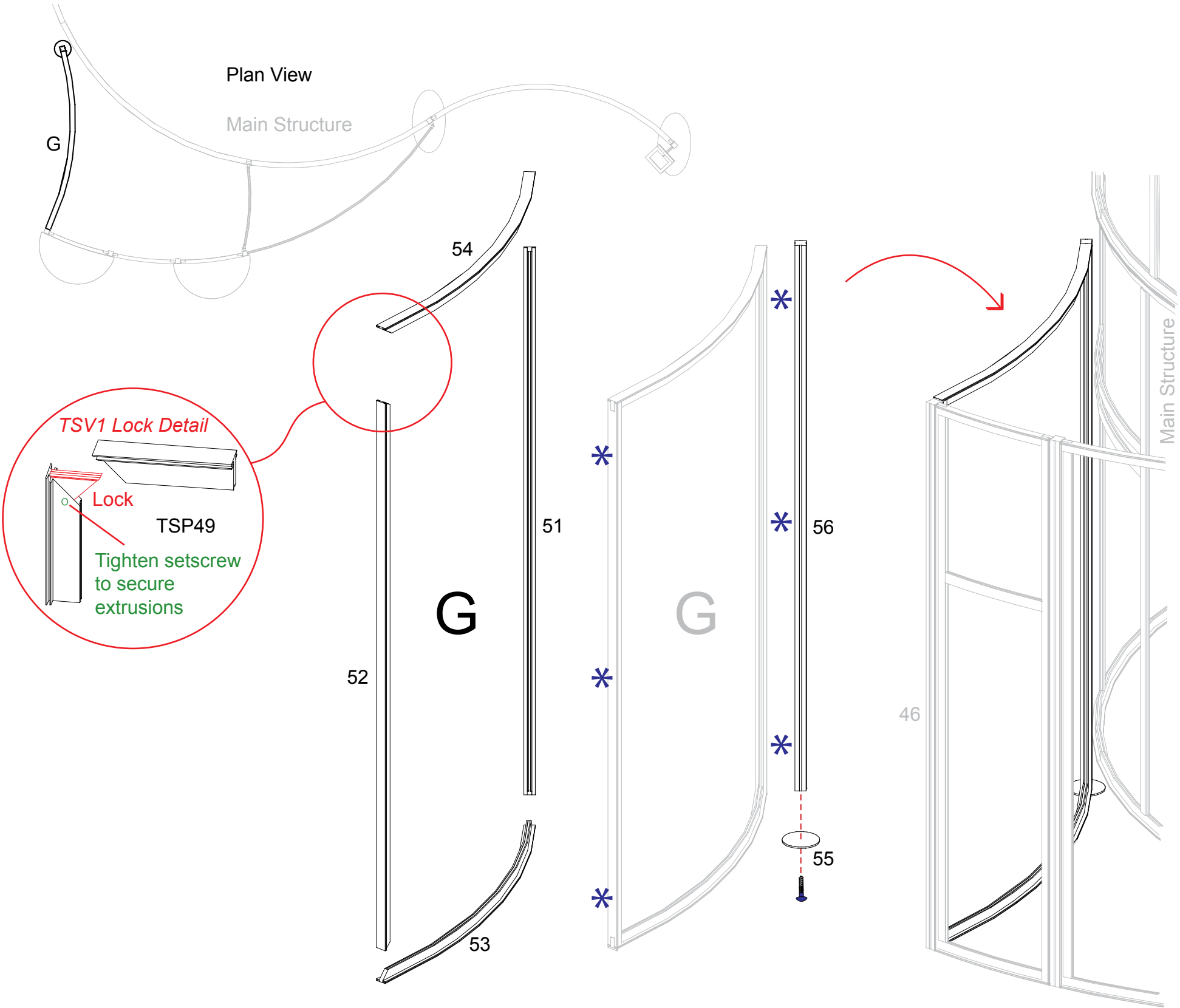

\*\*\*\*See attached SEG graphic installation for graphic attachment

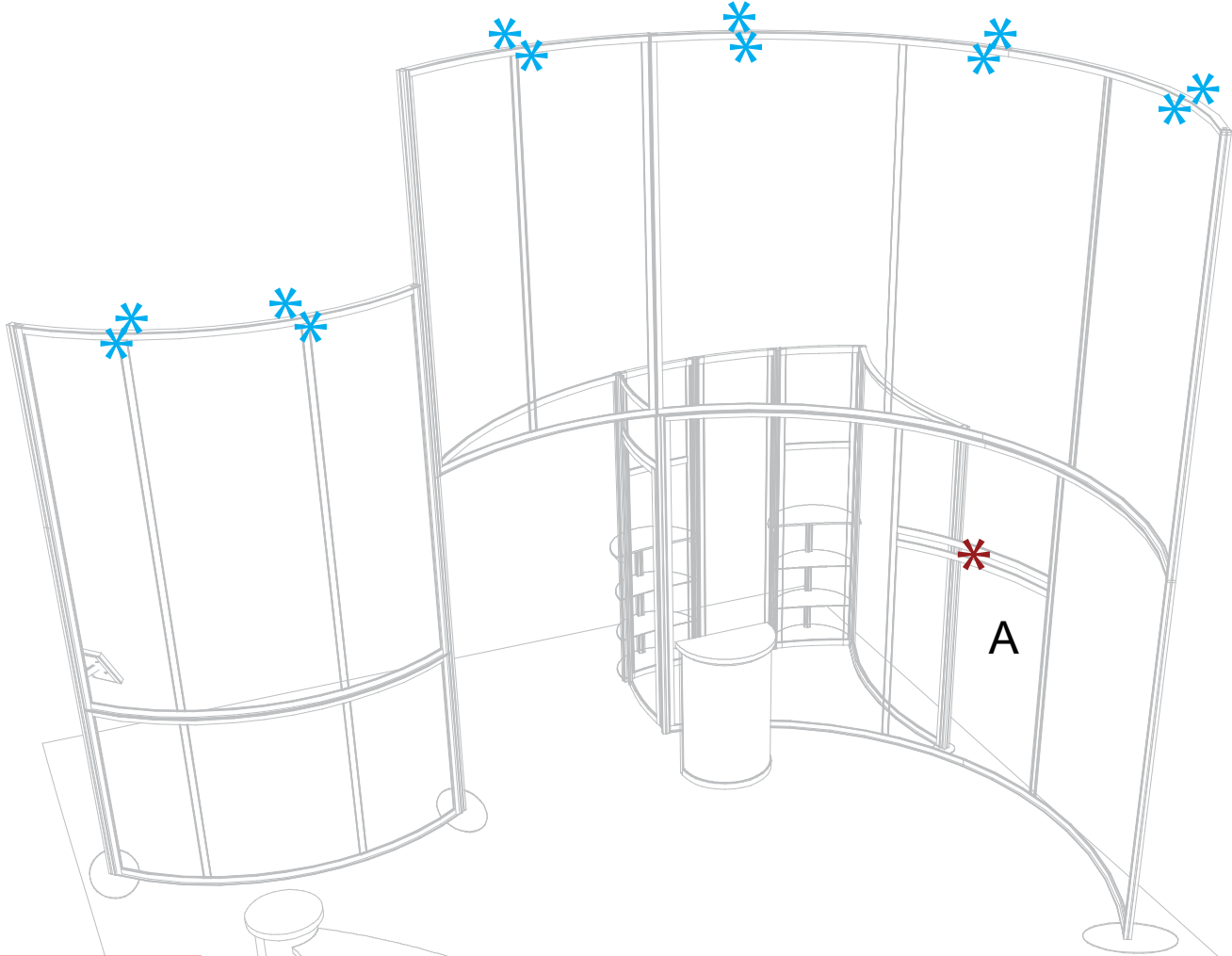
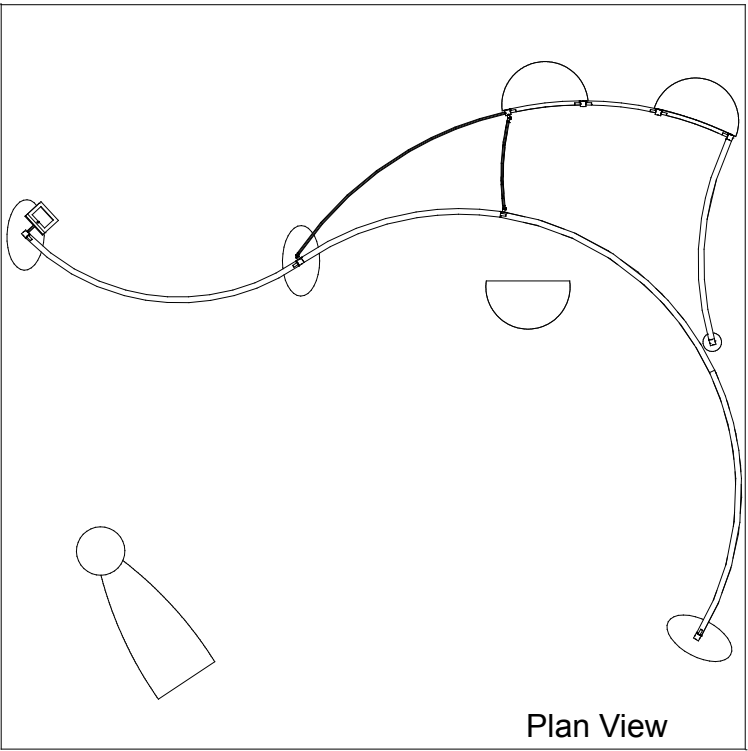
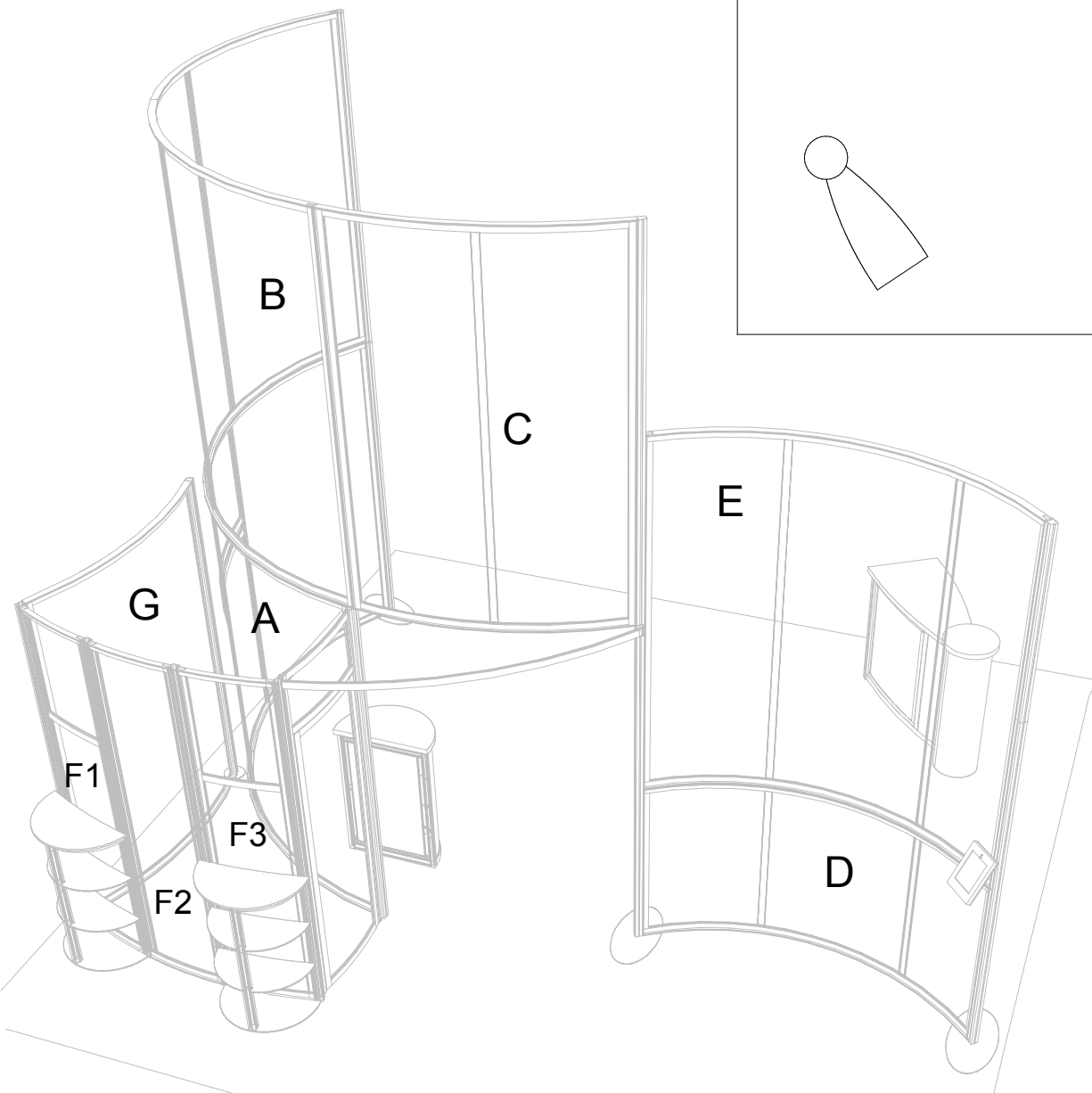

**\* Monitor Mount Attachment**

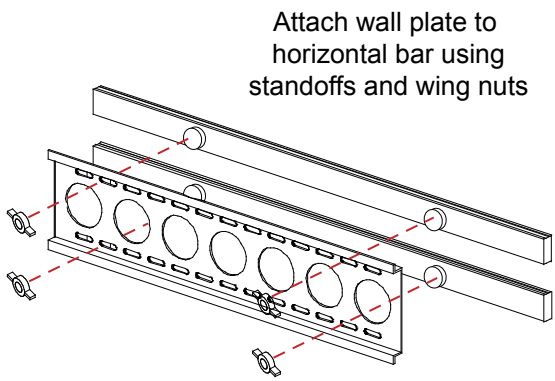

Attach wall plate to horizontal bar using standoffs and wing nuts

Hook monitor brackets over top of wall plate, then secure with safety bolts to bottom of monitor brackets.

**Example of Light Attachment**

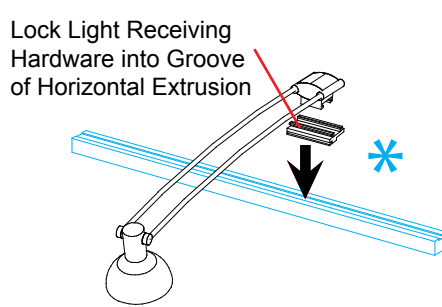

- Steps:
- 1) Attach monitor mount to frame [A]. Refer to detail.
  - 2) Apply SEG graphics to TSP49 frames [A-G].  
*See attached SEG graphic installation for graphic attachment*
  - 3) Attach lights atop assembled backwall. Refer to detail. \*



Item	Qty.	Description
57	1	82.7624" Z45 Curved Horizontal Extrusion
58	2	40"h S44 Vertical Extrusion
58a	2	Base Plate
59	2	19" Z45 Curved Horizontal Extrusion
60	2	19" Z45 Curved Horizontal Extrusion

- Steps:
- 1) Attach verticals [58] to base [58a] using screws as shown.
  - 2) Attach curved horizontals [59,60] to verticals [58] as shown.
  - 3) Attach curved horizontals [59,60] to backwall verticals [46 & 49] and [49 & 47].
  - 4) Place shelves on shelf pins between verticals and wall as shown.
  - 5) Place countertop on top of assembled shelving unit as shown.
  - 6) Attach curved horizontal [57] between verticals [47 & 41] as shown.

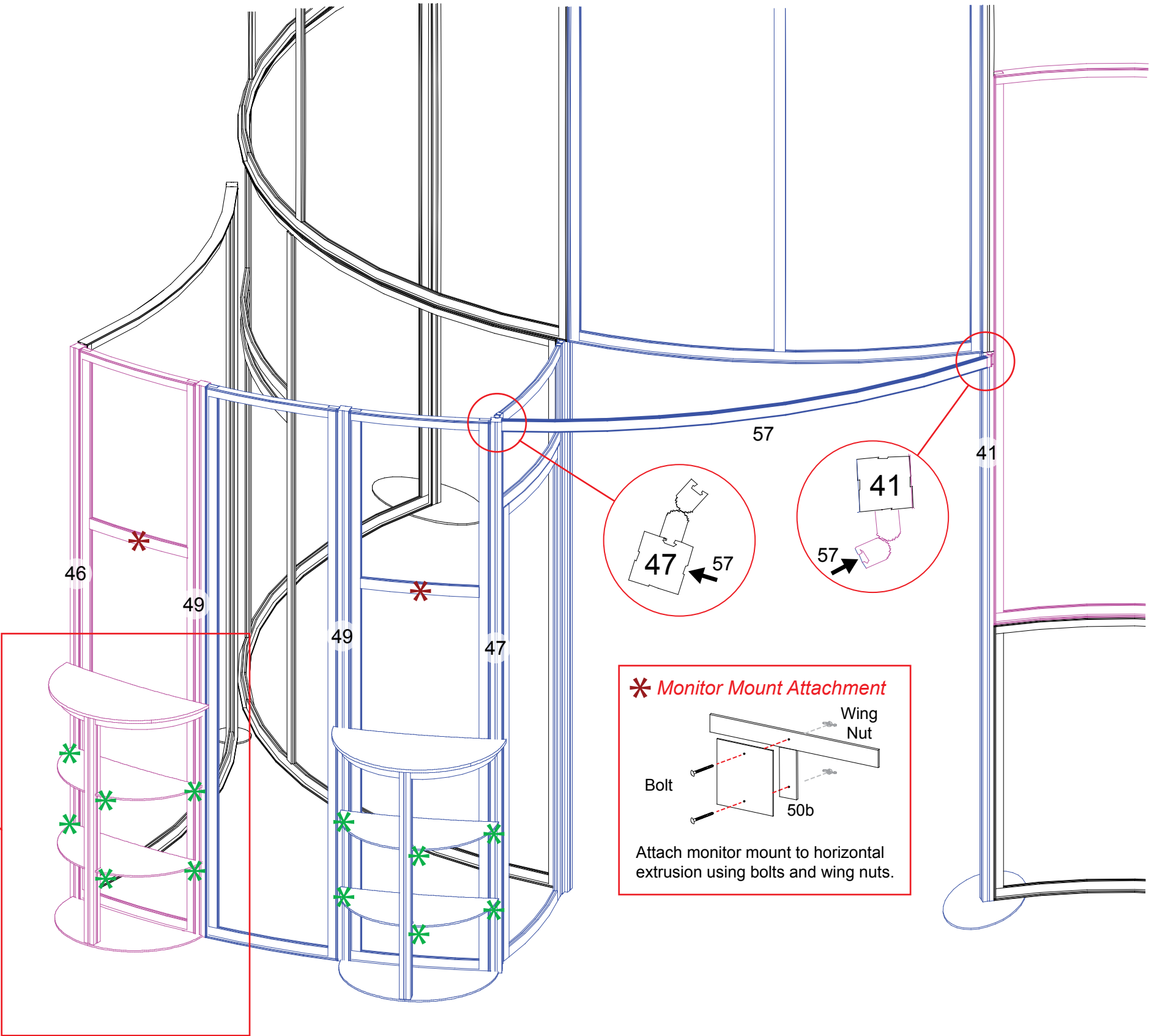
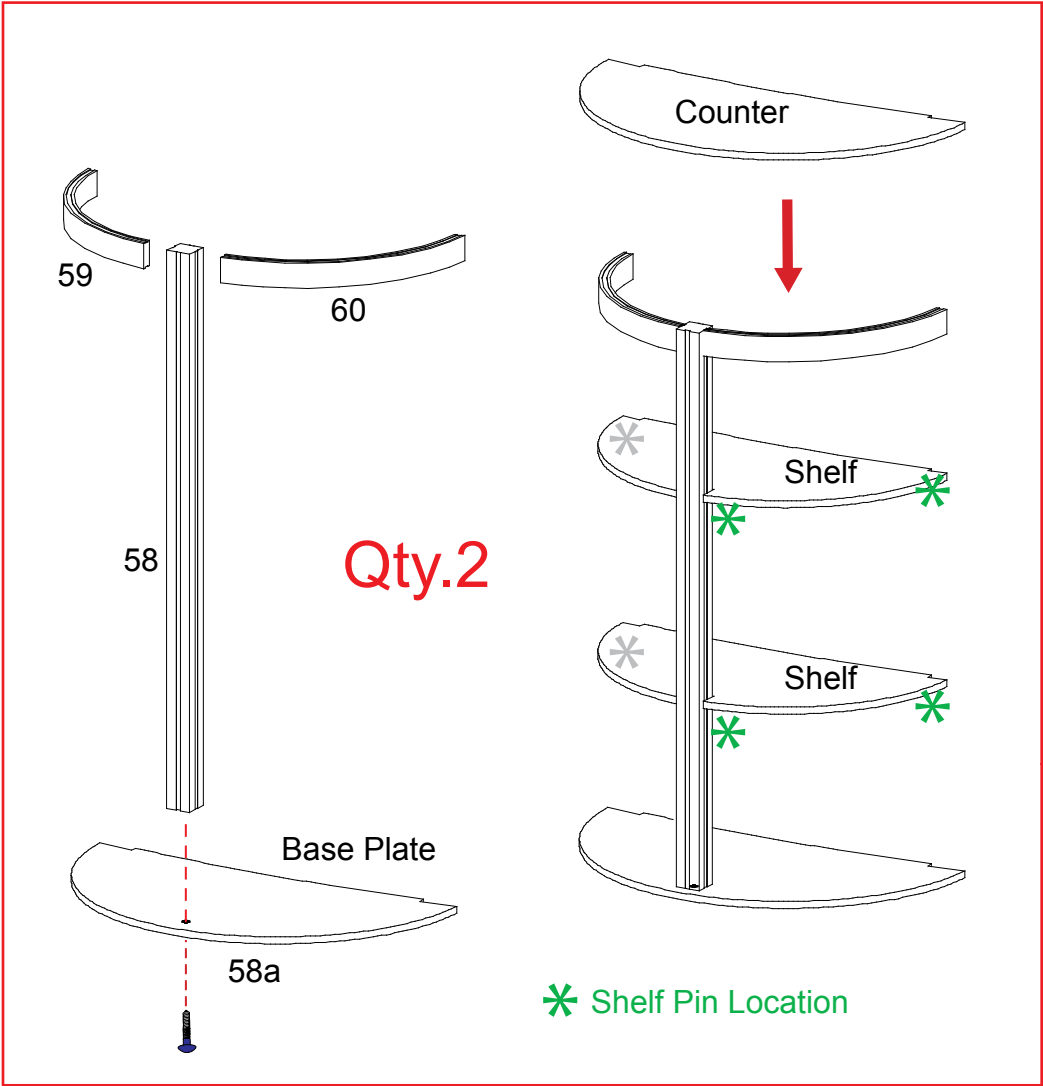

Item	Qty	Description
61	1	38" S44 Vertical Extrusion
62	1	38" S44 Vertical Extrusion
63	2	41.2385" Z45 Curved Horizontal Extrusion
64	2	41.2385" Z45 Curved Horizontal Extrusion
65	2	16.35" Z45 Horizontal Extrusion
66	1	34.41" Z45 Vertical Extrusion w/ Door Hinges

Item	Description
1	5.75"r x 42"h Half Curve Panel
2	5.75"r x 42"h Half Curve Panel

- Steps:
- 1) Attach curved panels [1,2] together.
  - 2) Attach lower horizontals [63,64,65] between assembled curved panels and verticals [61,62].
  - 3) Attach vertical [66] to lower horizontal [64], Placing infill as shown.
  - 4) Insert infills as shown.
  - 5) Attach upper horizontals [63,64,65] between assembled curve panels and verticals [61,62] atop infills.
  - 6) Hang door from hinges as shown in detail.
  - 7) Place internal shelf on shelf supports
  - 8) Set counter tops on top of assembled base.

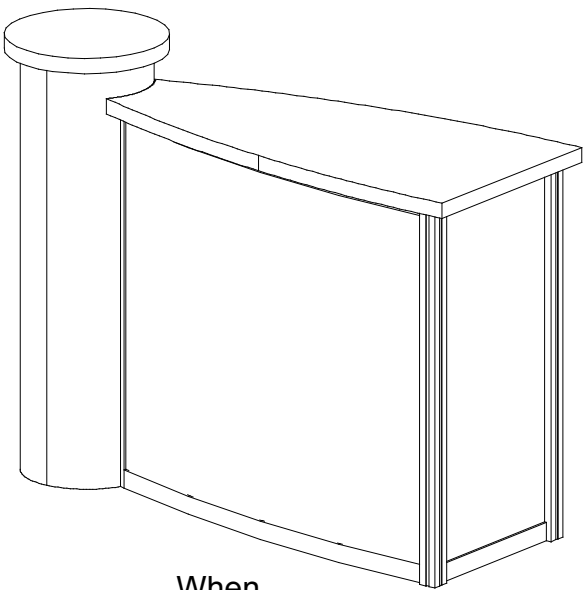
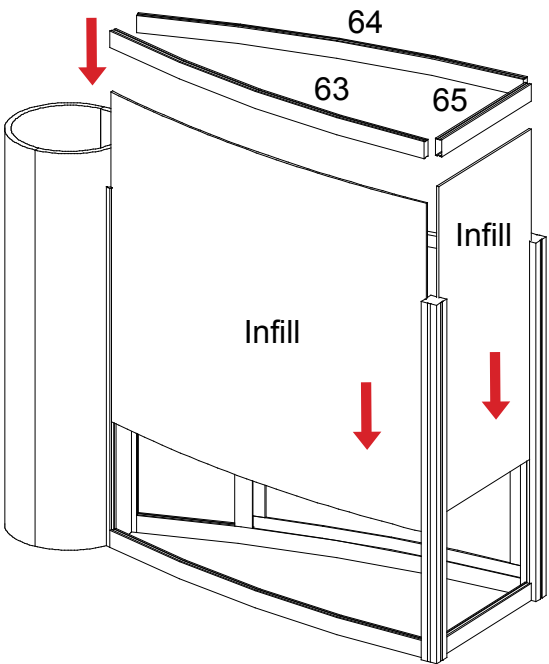
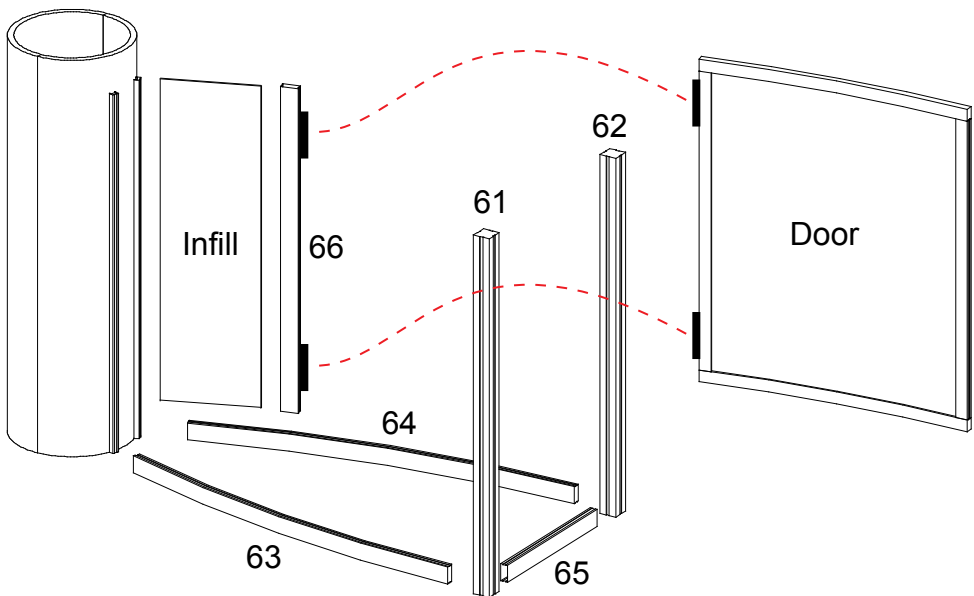
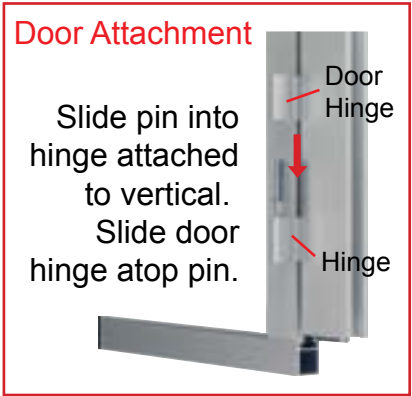
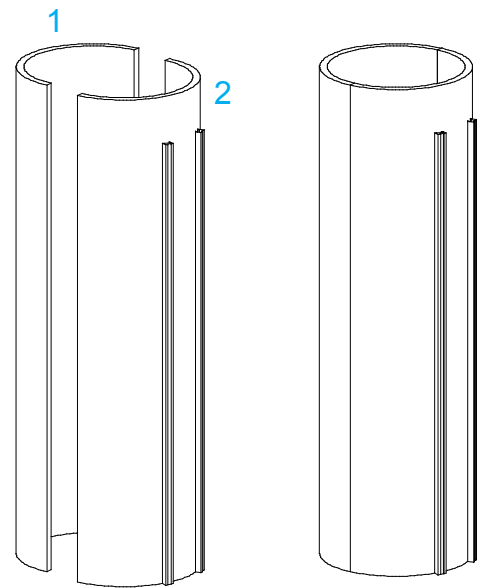

When assembled

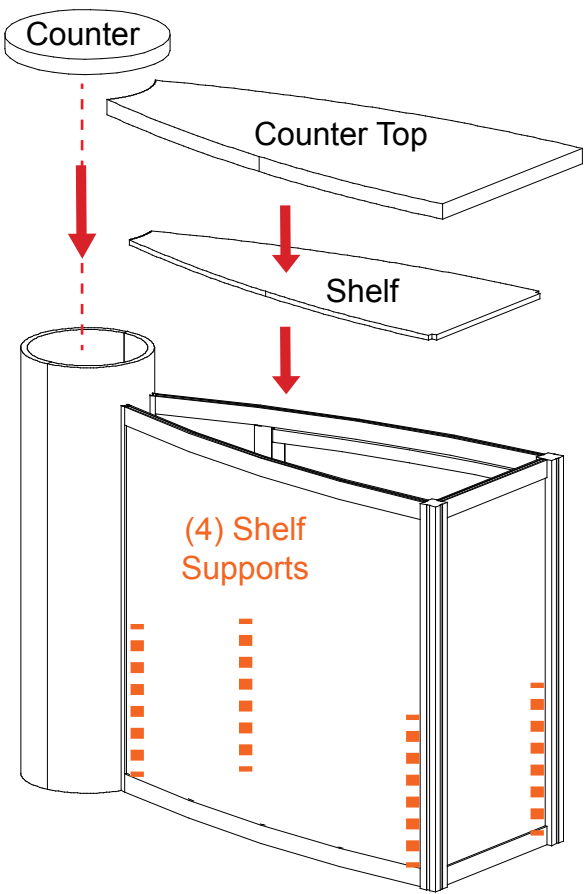



Item	Qty.	Description
67	1	40" GS220 Corner Vertical Extrusion
68	1	40" GS220 Corner Vertical Extrusion
69	2	23" Z45 Horizontal Extrusion
70	2	40.0695" Z45 Curved Horizontal Extrusion

- Steps:
- 1) Attach lower horizontals [69,70] between verticals [67,68].
  - 2) Attach door to vertical [67]. Refer to **Door Attachment** detail.
  - 3) Attach upper horizontals [69,70] between verticals [67,68].  
Note: Place infill between verticals and curved horizontals.
  - 4) Velcro attach shelf supports to inside of assembled pedestal.
  - 5) Place internal shelf on shelf supports.
  - 6) Set counter top on top of assembled pedestal.

