

**Supernova Lights**

**Light to Light Attachment**

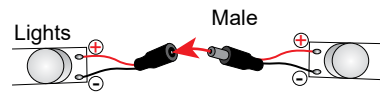

**Light to Transformer Attachment**

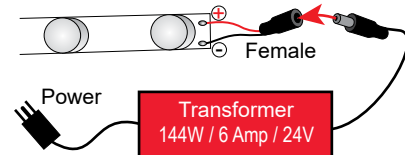

Maximum of 7 lights per chain / 12 lights per Transformer

**Steps:**

- 1) Connect power cords to Supernova lights in front & side lightboxes.
- 2) Apply SEG graphics to front & side frame of counter.

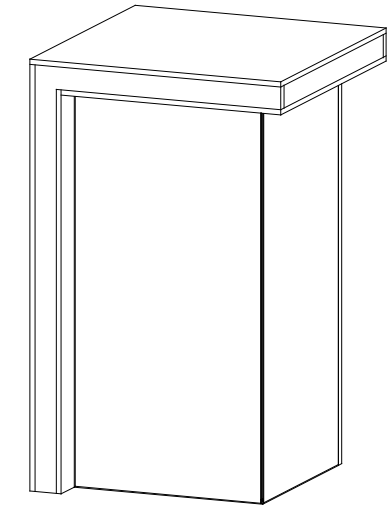

FRONT VIEW

**SEG Graphic Installation**

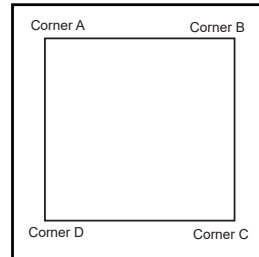

It is important to first insert graphic into each alternate corner, then to the sides of the frame. If this is not done, graphic will not fit into the frame correctly.



**Step 1**  
Insert corner A. Turn edge of graphic so silicon welt is perpendicular to face of graphic. Insert narrow side of welt with fabric to outside into the channel. Repeat for other side of this corner.



**Step 2**  
Repeat Step 1 for opposite corner C, then insert corner B, followed by corner D, to complete the installation of the corners.



**Step 3**  
Once all corners are inserted, press one silicon edge into channel from corners and work toward the center. Make sure welt is fully inserted into channel. Continue until all sides are done. Smooth out edges of graphic.

**Graphic Removal**



To remove the graphic from the frame, locate the fabric pull tab. Gently pull up on the tab to remove the fabric.

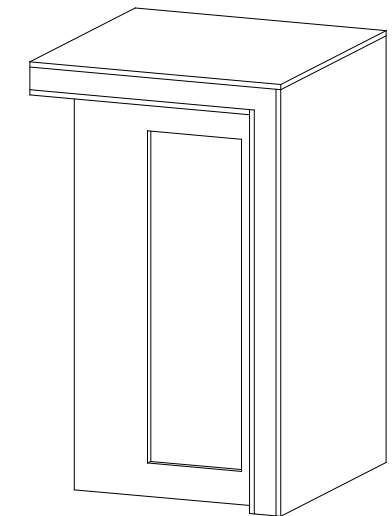
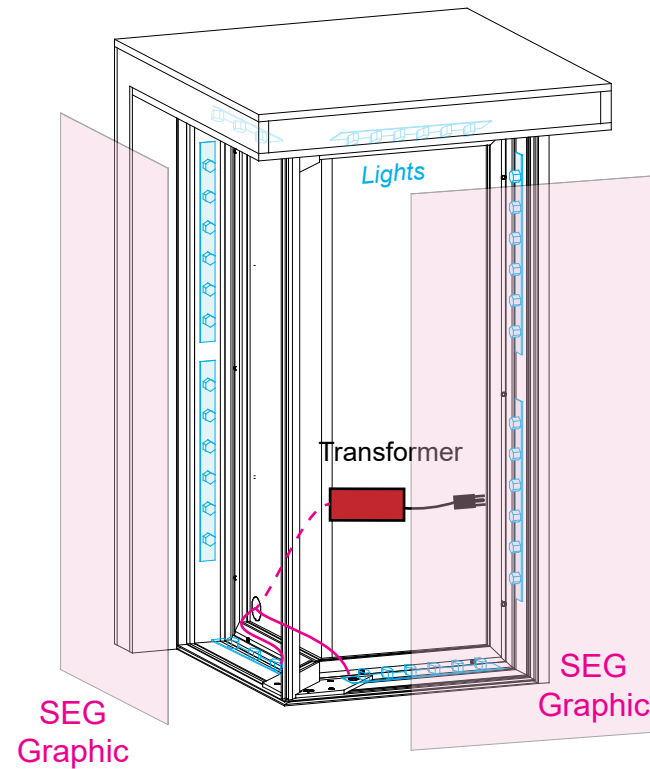

BACK VIEW

*Keep counter assembled for shipment.  
DO NOT DISASSEMBLE.*

**SETUP INSTRUCTIONS**